

COMMON PRODUCT NAMING GUIDE

2021 STANDARDS

2cd EDITION



ARCHITECTURAL BRASS

PROPRIETARY AND CONFIDENTIAL

THE INFORMATION CONTAINED IN THIS BOOK IS THE SOLE PROPERTY OF ARCHITECTURAL BRASS COMPANY. ANY REPRODUCTION IN PART OR AS A WHOLE WITHOUT THE WRITTEN PERMISSION OF THE COMPANY IS PROHIBITED.

PRODUCED BY TRISHA STONEBURG

TOPS DESCRIPTIONS

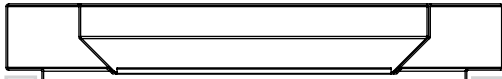

2" RAISED TOP
WITH 90DEG BEND AND FUNNEL



OVER BODY FUNNEL

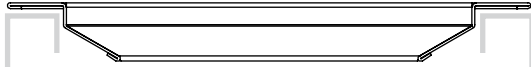

FLAT TOP

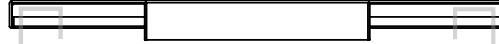

OVER BODY STRAIGHT FUNNEL



INLAVED INTO TOP OF BODY

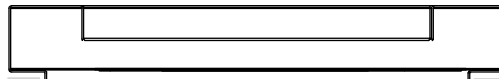

TOP
2" RAISED TOP
WITH 90DEG BEND AND FUNNEL

BOTTOM DESCRIPTIONS



TOE KICKS
RECESSED FROM THE BODY



BASE
FLUSH WITH THE BODY

1904 SERIES

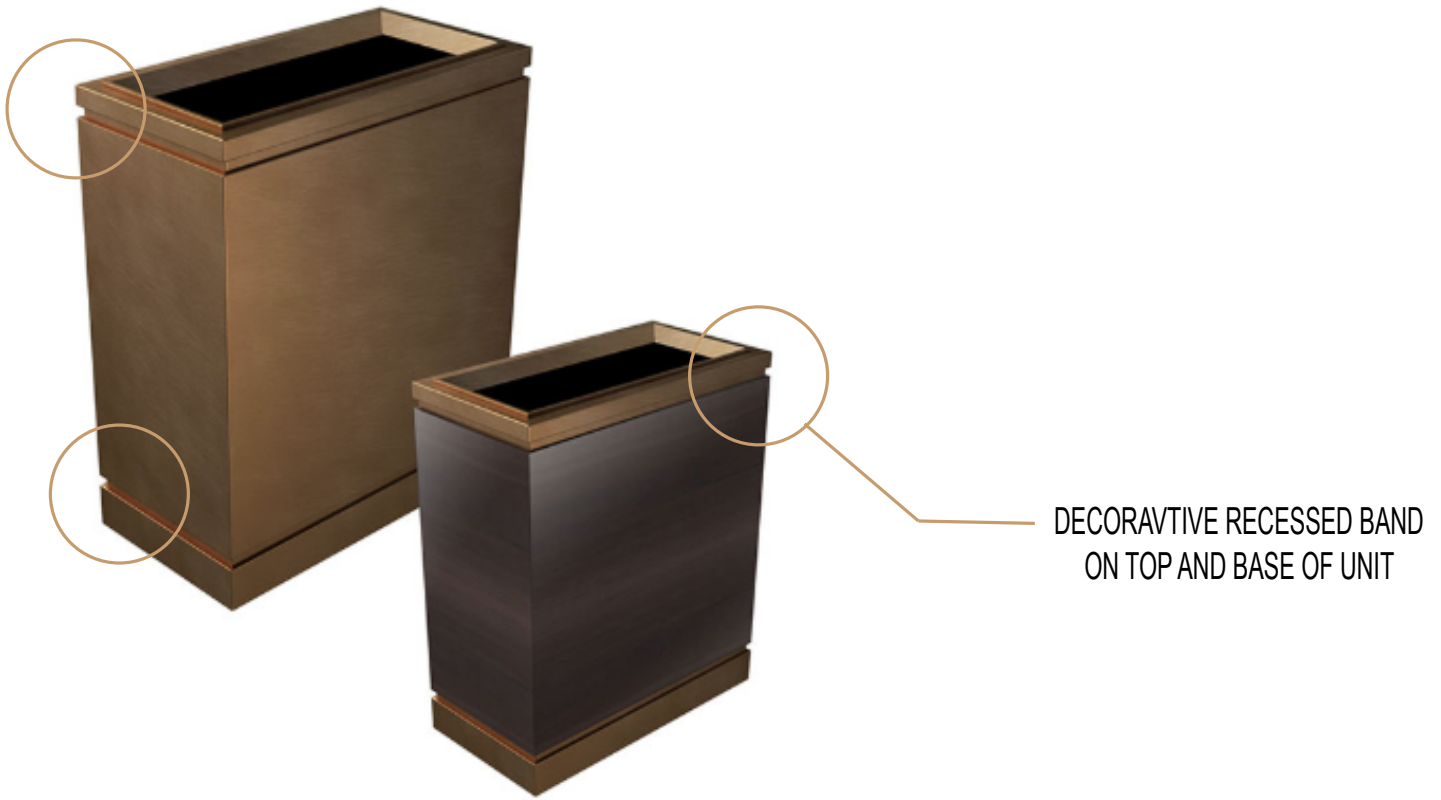

ALIANTE STATION SERIES

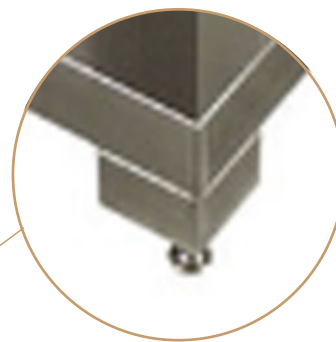

FLUSH RAISED BASE WITH ADDITION TOE KICK LEGS

ARIA SERIES



'2 TIERED' BASE AND
RECESSED TOE KICK



RED ROCK SERIES



OVERSIZED EXTENDED TOP

WIDE CORNER
GUARDS

OVERSIZED EXTENDED BASE

AURORA I SERIES



DECORATIVE BANDS
1 TO 2 ON EACH CORNER
(7.5"X4" X .5"H)

2" RECESSED TOE KICK



AURORA II SERIES



SINGLE RECESSED BAND
IN CENTER OF UNIT

2" RECESSED TOE KICK

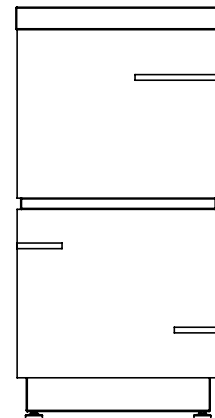

BENTLEY SERIES



WIDE CORNER GUARDS

TALL BANDING AROUND BASE AND TOP



BENTLEY II SERIES



SMALL CORNER GUARDS AROUND ENTIRE UNIT MADE OUT OF 1"X1" ANGLE

1" SINGLE CENTER VERTICAL BAND

TALL BANDING AROUND BASE AND TOP

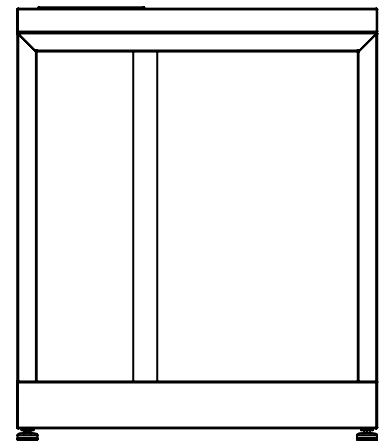

BELLINI SERIES



1 TOP DECORATIVE BAND
AROUND UNIT

2 BTM DECORATIVE BANDS
AROUND UNIT

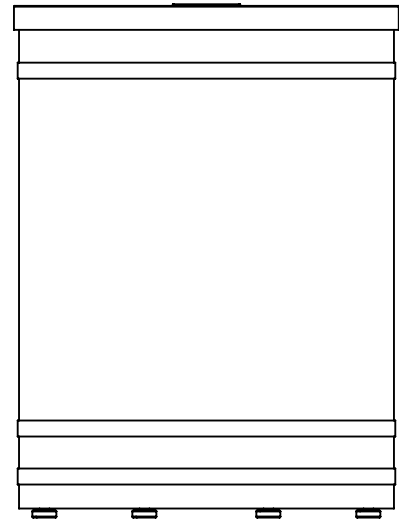
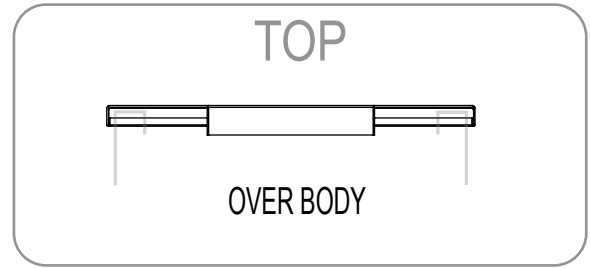

BOXANA SERIES



3 TAPERED SIDES
AND ONE STRAIGHT SIDE

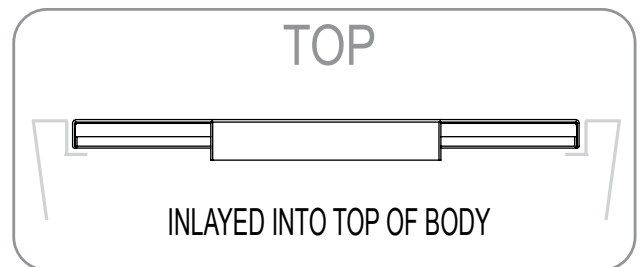

EUROLINE SERIES



OVERSIZED EXTENDED TOP

OVERSIZED EXTENDED BASE

HALF ROUND SERIES



NO TOE KICK OR BASE

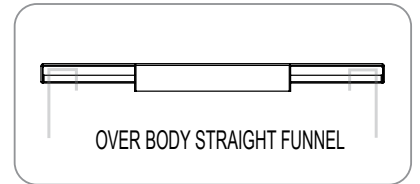
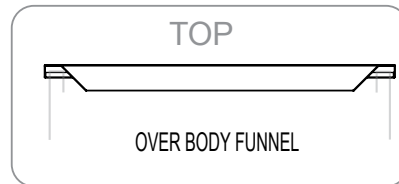

PANDORA SERIES



RAISED BASE
FLUSH WITH BODY



STRAIGHT EDGE SERIES



NO DECORATIVE
TOP OR BODY

NO TOE KICK OR BASE

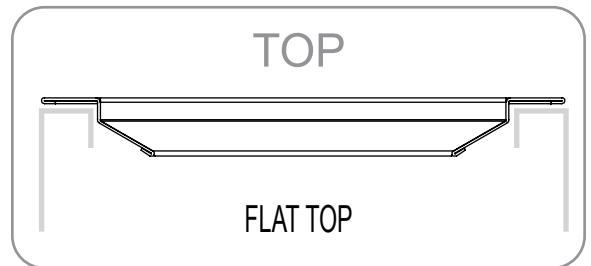

STRAIGHT EDGE
TAPERED SERIES

EDGEWOOD SERIES *NEW*

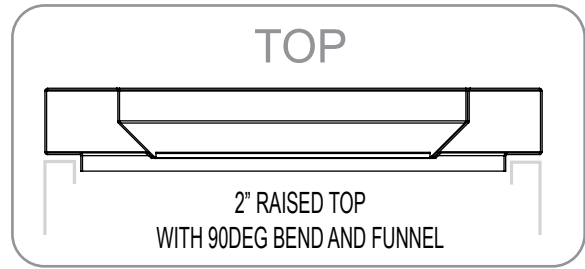

RAISED BASE
FLUSH WITH BODY

KIRKWOOD SERIES *NEW*

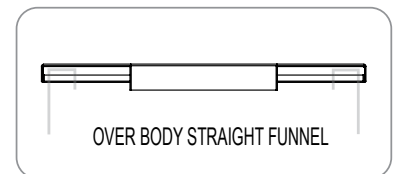

RAISED BASE
FLUSH WITH BODY



KIRKWOOD
TAPERED SERIES

BANKHEAD SERIES *NEW*



2" RECESSED TOE KICK



MIDTOWN SERIES *NEW*



DECORATIVE RECESSED BAND
ON TOP OF UNIT

WIDE CORNER
GUARDS

TALL BANDING
AROUND BASE AND TOP



MATRIX SERIES



INWARD TOP FUNNEL

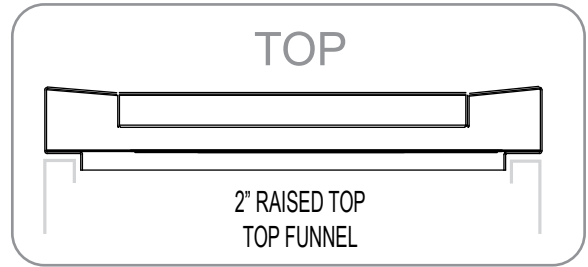

THIS IS A UNIQUE TOP

NO TOE KICK OR BASE

HAPEVILLE SERIES *NEW*



FLAT TOP



NO TOE KICK OR BASE

OAKHURST SERIES *NEW*

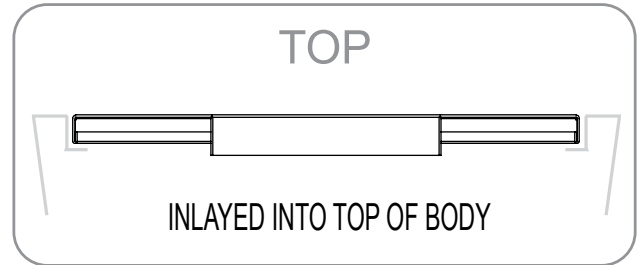

NO TOE KICK OR BASE

DECATUR SERIES *NEW*

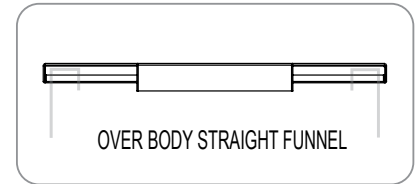
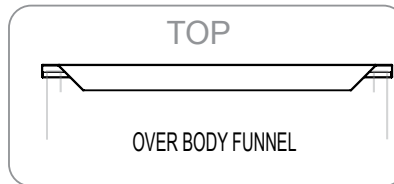

DECATUR
TAPERED SERIES



DECATUR
ROUND SERIES

NO TOE KICK OR BASE

TAPERED AND ROUND UNIT NAMING GUIDE



Tapered and round units are named based off their top and bottom options.

For an example, a regular Decatur series has a non-decorative body, no toe kick or base with a overlay top

NO TOE KICK OR BASE

If you have a tapered unit with the characteristics of a Decatur then it will be a Decatur Tapered Series



DECATUR
TAPERED SERIES

If you have a round unit with the characteristics of a Decatur then it will be a Decatur round Series



DECATUR
ROUND SERIES

TAPERED SERIES



RAISED TOP TO SIT ON TOP OF UNIT

NO TOE KICK OR BASE

TAPERED VARIATIONS WITH NEW NAMES

STRAIGHT EDGE
TAPERED SERIES



DECATUR
TAPERED SERIES



KIRKWOOD
TAPERED SERIES



BUCKHEAD SERIES *NEW*

IF A UNIT HAS A STRAIGHT BODY
WITH OVERLAY TOP
AND RECESSED TOE KICK

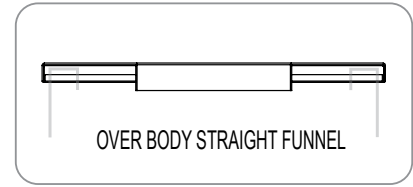
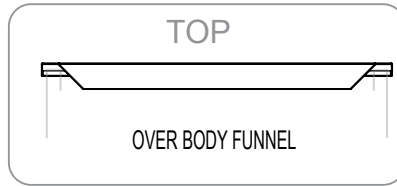

2" RECESSED TOE KICK



BUCKHEAD ROUND
SERIES

NEW